



2024-25 SEASON | SIDEWALK VEHICLE EQUIPMENT





SNOWRATOR®

Right-Sized Power and Performance.

Standard Features

- BOSS Engineered Electrical System
- Float and Active Down Force
- Four-Wheel Drive with Zero Turn Radius Capabilities
- 3 LED Worklights
- BOSS Designed 4' Hydraulic Snowplow
- BOSS Hydraulic Cylinders and Trip Springs
- 20-Gallon Anti-Icing/Deicing Brine System
- 1/4" 1080 Steel Reversible Cutting Edge

Optional Attachments

- EXACT PATH® 1.5 Cubic Foot Drop Spreader
- 20-Gallon Auxiliary Tank
- TGS 85 Broadcast Spreader



SEE IT IN ACTION



Optional Accessories

- Snow Deflector
- Blade Guides
- Blade Extensions
- Box Wing Kit
- Urethane Cutting Edges
- $\frac{3}{8}$ " AR450 Extended Wear Cutting Edge
- Plow Shoes
- Turf Defender
- Shovel Mounting Kit
- 5-Gallon Bucket Mount
- Carry Trays
- Snow Flaps
- Cover

Product Specs

SNOWRATOR®

Model

77"

Vehicle Length

39"

Vehicle Width

48"

Plow Width

827 lbs

Vehicle Weight

Kohler® CH440 cc Carbureted Engine
Engine Manufacturer

5 mph | 3 mph
Speed Forward | Reverse



BIGGER. BADDER. BOLDER.

Standard Features

- BOSS Engineered Electrical System
- Float and Active Down Force
- Four-Wheel Drive with Zero Turn Radius Capabilities
- 3 LED Worklights
- 690 Cold Cranking Amps
- 8-Gallon Fuel Capacity
- BOSS Hydraulic Cylinders
- Kohler® EFI Engine
- Electronic Throttle Body Engine
- 25° of Lift and 17° of Depression
- Engine Directed Heat to Operator
- Cup Holder
- Onboard Diagnostics
- Operator Presence Switch
- Stainless Steel Chassis

Optional Accessories

- Snow Deflector
- Blade Guides
- Blade Extensions
- Box Wing Kit
- Urethane Cutting Edges
- 3/8" AR450 Extended Wear Cutting Edge
- Plow Shoes
- Turf Defender
- Shovel Mounting Kit
- 5-Gallon Bucket Mount
- Carry Trays
- Snow Flaps



SEE IT IN ACTION



Optional Implements

- 4'2" XT Plow
- 4' and 5' Straight-Blade Plows
- 48" STX Snow Thrower
- 48" BRX Broom

Optional Attachments

- TGS 85 Broadcast Spreader
- EXACT PATH® 1.5 Cubic Foot Drop Spreader
- 40-Gallon Brine System

Product Specs

SR MAG

Model

60"

Vehicle Length*

39"

Vehicle Width*

52"

Vehicle Height

1,046 lbs

Vehicle Weight*

Kohler® ECH 749 cc EFI Engine
Engine Manufacturer

8 mph | 5 mph
Speed Forward | Reverse

IMPLEMENTS



4'2" XT Plow

4'2" V-Plow features AR450 cutting edges, built-in snow catcher and curb guards.



STX48 Snow Thrower

48" snow thrower moves snow 2-35 feet with a 14.5 horsepower, 2,500 psi motor.



BRX48 Broom

48" broom with long-lasting bristles works in forward or reverse.



4' and 5' Straight-Blade Plows

Tough 4' and 5' straight-blade plows quickly adapt to any job at hand.

ATTACHMENTS



TGS 85 Broadcast Spreader

Rear-mounted Poly TGS 85 Broadcast Spreader features a 1/6-horsepower motor and can accommodate up to 50 lbs of deicing material.



EXACT PATH® 1.5 CU. FT. Drop Spreader

EXACT PATH® dispenses precise amounts of deicer precisely where needed, preserving grass and landscaping. Can accommodate up to 150 lbs of deicing material.

40-Gallon Brine System

Pre-treat and/or post-treat with this top mounted, easy-to-install brine tank attachment. The liquid technology offers adjustable flow rates at speeds ranging from 2 to 8 mph and a translucent tank for easy-to-read capacity.

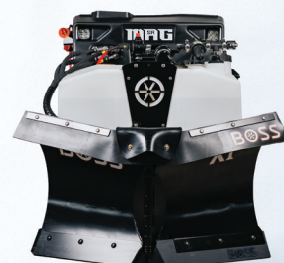

MAG

IMPLEMENTS & ATTACHMENTS

Expertly Crafted Solutions.



CHECK OUT THE
NEW BRINE SYSTEM





FIND THE RIGHT SIDE

BOSS offers a solution for all your sidewalk needs, regardless of size. From the alpha in snow and ice control, the SR MAG, to the compact SR Scout, and the tried-and-true Snowrator®, BOSS has the right sidewalk solutions to BACK YOU UP. Take a look at the strengths of each of member of the sidewalk vehicle family.

| Attachments | SR Scout | Snowrator® | SR MAG |
|----------------------|----------|------------|--------|
| 4'2" XT | ❌ | ❌ | ❌ |
| 4' Straight-Blade | ❌ | ❌ | ❌ |
| 5' Straight-Blade | ❌ | ❌ | ❌ |
| 48" STX Snow Thrower | ❌ | ❌ | ❌ |
| 48" BRX Broom | ❌ | ❌ | ❌ |
| EXACT PATH® | ❌ | ❌ | ❌ |
| TGS 85 | ❌ | ❌ | ❌ |
| 40-Gal Brine Kit | ❌ | ❌ | ❌ |
| 20-Gal Brine Kit | ❌ | ❌ | ❌ |
| Bucket Mount | ❌ | ❌ | ❌ |

| Electrical | SR Scout | Snowrator® | SR MAG |
|-----------------------|----------|------------|--------|
| Electric Start | ❌ | ❌ | ❌ |
| Battery CCA | 350 | 350 | 690 |
| Charging System (amp) | 18 | 18 | 50 |
| Keyed Power | ❌ | ❌ | ❌ |
| Front Lights | 2 STD | 2 STD | 2 STD |
| Rear Light | 1 STD | 1 STD | 1 STD |
| Lumens per Light | 1200 | 1200 | 1200 |
| Lumens Total | 3600 | 3600 | 3600 |

| Engine | SR Scout | Snowrator® | SR MAG |
|---------------------------|----------|------------|---------|
| Displacement | CH440 cc | CH440 cc | 749 cc |
| Engine Manufacturer | Kohler | Kohler | Kohler |
| Engine Type (Carb or EFI) | Carb | Carb | EFI |
| Electronic Throttle Body | ❌ | ❌ | ❌ |
| Cooling System | AIR | AIR | AIR |
| Fuel | GAS | GAS | GAS |
| Fuel Capacity | 1.85 GAL | 1.85 GAL | 8.0 GAL |

| Drive | SR Scout | Snowrator® | SR MAG |
|-------|------------|------------|------------|
| 4x4 | ❌ | ❌ | ❌ |
| Type | Skid Steer | Skid Steer | Skid Steer |

| Speed | SR Scout | Snowrator® | SR MAG |
|---------|----------|------------|--------|
| Forward | 6 MPH | 5 MPH | 8 MPH |
| Reverse | 4 MPH | 3 MPH | 5MPH |



DEWALK SOLUTION

| Vehicle | SR Scout | Snowrator® | SR MAG |
|---------------------|------------|-----------------|-----------------|
| Turning Radius | Zero Turn | Zero Turn | Zero Turn |
| Approach Angle | 33.5° | 21.5° | 47° |
| Departure Angle | 22° | 21.8° | 28.72° |
| Break Over Angle | 54° | 71.7° | 57.6° |
| Lift Height | 14.5" | 11.81" | 14.28" |
| Down Pressure Angle | 5° | 15.3° | 17.5° |
| Ground Clearance | 5.25" | 5.17" | 6" |
| Lift Angle | 32° | 25° | 25° |
| Length | 73.5" | 77.31" | 60" |
| Width | 34" | 39" | 39" |
| Height | 48" | 54.16" | 52" |
| Weight | 800 lbs | 827 lbs | 1,046 lbs |
| Wheelbase | 25" | 24" | 26.5" |
| Tires | 18x8.5-10 | 18x8.5-10 | 18x8.5-10 |
| Chassis | Mild Steel | Stainless Steel | Stainless Steel |

| Hydraulics | SR Scout | Snowrator® | SR MAG |
|------------------------------|----------|------------|--------|
| High Flow Hydraulics | ❖ | ❖ | ❖ |
| Low Flow Hydraulic Circuits | 2 | 2 | 2 |
| Quick Disconnect (High Flow) | ❖ | ❖ | ❖ |
| Quick Disconnect (Low Flow) | ❖ | ❖ | ❖ |
| Warranty | SR Scout | Snowrator® | SR MAG |
| Three-Year | ❖ | ❖ | ❖ |
| Operator Features | SR Scout | Snowrator® | SR MAG |
| 12V Charging Port | ❖ | ❖ | ❖ |
| Onboard Diagnostics | ❖ | ❖ | ❖ |
| Foldable Operator Platform | ❖ | ❖ | ❖ |
| Operator Warming | ❖ | ❖ | ❖ |
| Cup Holder | ❖ | ❖ | ❖ |

SIDEWALK

ACCESSORIES & ATTACHMENTS





SEE MORE

BLADE PERFORMANCE



Box Wing Kit

These wings easily bolt to the 4' and 5' straight-blade snowplows, providing a box-plow effect.



Rubber Snow Deflector

Increase visibility with this rugged snow deflector. (Compatible with 4'2" XT and 4' and 5' straight-blade plows.)



Urethane Cutting Edges

Optimum squeegee effect. Also prevents damage to sensitive surfaces. (Compatible with 4'2" XT and 4' and 5' straight-blade plows.)



Blade Extensions

Extend the width of your 4' and 5' straight-blade plows by 12" overall (6" on each side).

PLOW ENHANCEMENTS



Plow Shoes

Reduce wear and tear on the plow's cutting edge.



Blade Guide

Get a better view of the exact width of your blade with these sturdy blade guides.

DEICING ATTACHMENTS



TGS 85 Broadcast Spreader

Rear-mounted Poly TGS 85 Broadcast Spreader features a 1/8-horsepower motor and can accommodate up to 50 lbs of deicing material. (Not compatible with SR Scout.)



20-Gallon Auxiliary Tank

Integrates with existing pump, nozzles and wand. Cuts return trips to refill by half. (Not compatible with SR Scout or SR MAG.)

EXACT PATH® 1.5 Cubic Foot Drop Spreader

Dispenses precise amounts of deicer precisely where needed, preserving grass and landscaping. Can accommodate up to 150 lbs of deicing material. (Not compatible with SR Scout.)



VEHICLE ENHANCEMENTS

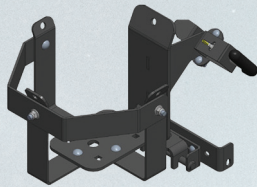

5-Gallon Bucket Mount

Attaches simply to give the operator easy access to additional deicing materials.



Snow Flap

Protects your Snowrator® fenders and exterior from snow, mud and debris.



Carry Trays

Keep additional gear, fuel and deicing materials in easy reach on your Snowrator® (not compatible with SR Scout or SR MAG).

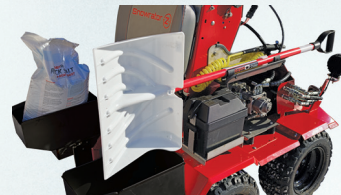

Shovel Mounting Kit

Carry a shovel right on your machine to quickly clean up around doorways and hard-to-reach areas.

TOOLS



Pusher & Scoop Shovels

These high-performance, contractor-grade snow shovels are built BOSS tough. Pusher shovels available in 28", 36" and 48" widths.



Snowrator® Cover*

Protect your investment and keep it ready to roll with this heavy-duty, weather-resistant cover.

*Cover shown with opacity to show fit. Requires removal of front attachment for SR MAG.



5-Gallon Buckets & Lids

Be ready for the worst weather with buckets that let you carry additional supplies and materials to any job site. (Buckets and lids sold separately.)



Snowrator®, SR Scout & SR MAG Hydraulic Fluid

This high-performance fluid is specifically formulated for top performance under tough conditions.

THREE-YEAR LIMITED WARRANTY

All BOSS Snowrators, SR Scouts and SR MAGs are guaranteed to be free from defects in material and workmanship for three full years from the date of purchase. Stop by any authorized BOSS Snowrator® Dealer to receive complete details on our two-year parts and labor warranty. Please visit bossplow.com for more details.

LEGAL STATEMENT

BOSS Products reserves the right under its product improvement policy to change construction or design details and furnish equipment when so altered without reference to illustrations or specifications used herein. BOSS Products may be protected by one or more patents; please see bossplow.com for more details.

*All images shown may include standard/optional equipment. Please consult your local BOSS Dealer for more information.



Enhance the power, performance and durability of your BOSS product with Genuine BOSS Parts & Accessories. Ask your dealer for information or shop online at bossplow.com.



SEE MORE

